



Filter Business Division

NINGBO NEWLAND MAGNET INDUSTRY
CORPORATION LIMITED
No. 411 Yin Dong North Road, Yin Zhou Economic
Development Zone, Yin Zhou , Ningbo

www.neomax.cn

New Magnet
New Application
Newland!

Company Profile

公司简介

Sintered Neodymium Magnet is a rare earth material mixture composition of rich rare earth phase, rich boron phase and other metallic material. The typical raw materials used were known as Praseodymium-Neodymium, Pure Iron and Iron-Boron.

We are the biggest manufacturer of magnetic bars in China with Europe being our main market:

烧结钕磁体是由富稀土相、富硼相和其他金属材料组成的稀土材料混合物。典型的原材料被称为镨钕，纯铁和铁硼。

我们是中国最大的磁棒制造商，欧洲是我们的主要市场:



- Well-developed automatic assembling line greatly advances the efficiency of magnetic bar assembling and saves labor cost.
完善的自动化装配线大大提高了磁棒装配效率，节约了人工成本。
- With high-efficiency production line, we now have reached the output of 100,000 pcs magnetic bars per month.
我们拥有高效的生产线，目前产量已达到每月10万根磁棒。
- We still keep on researching the second generation auto assembling machine to save more cost for our customers.
我们还在继续研发第二代自动化装配机器，能为客户节约更多的成本。
- The quality of magnetic bars which assembled by the machine is much more stable than by manual work which practiced by other companies.
该机器装配的磁棒质量比其他公司的手工装配的质量稳定得多。
- High quality control is our promise to customers. Each magnetic bar will be double checked before shipping.
高质量的控制是我们对客户的承诺。每个磁棒在装运前都要经过双重检查。
- Magnets supplied by our own magnet factory. Reliable magnet cost and competitive price.
磁铁由我们自己的磁铁工厂供应，磁铁成本可靠，使磁棒价格更具竞争力。

If interested in our company, welcome to visit our factory!
如果您对我们的公司感兴趣，欢迎来我司参观！



Magnetic Filter Bars

磁性过滤棒

Magnetic Filter Bar is consisted of stainless steel tube and strong NdFeB magnet. They can effectively remove ferrous chips and metal particles from free flowing materials

磁性过滤棒由不锈钢管和强钕铁硼磁铁组成。它们能有效地从自由流动的材料中去除铁屑和金属颗粒。

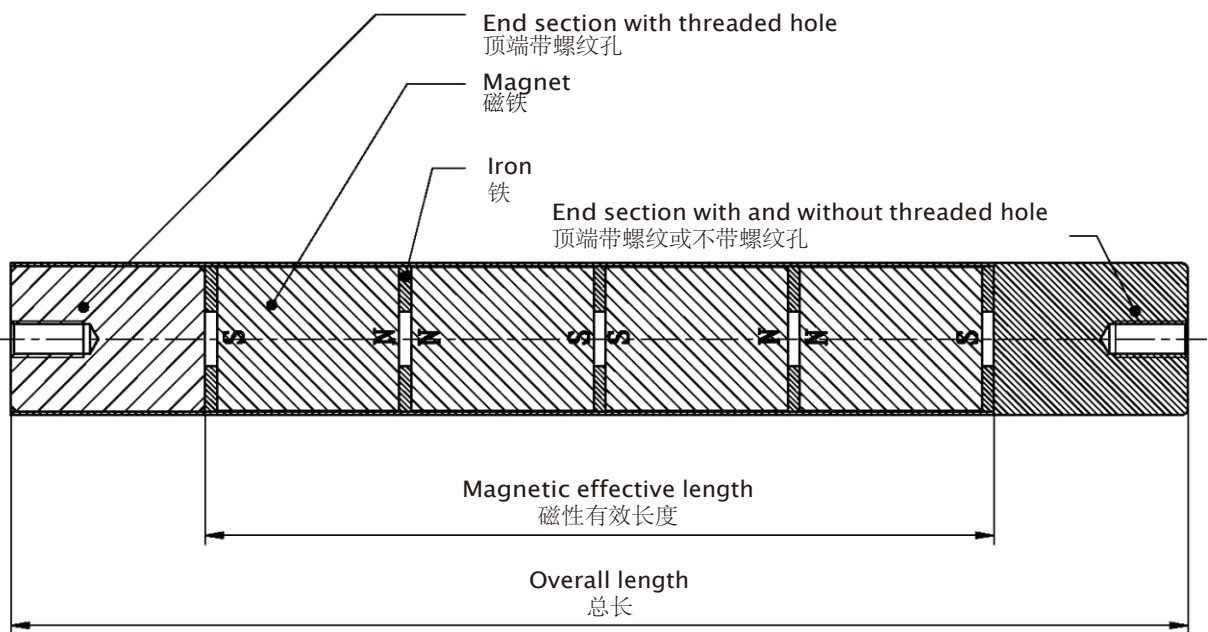

Technical Data

技术数据

- The standard diameter we supply is D10, D19, D20, D25, D25.4, D32, D50.8 and etc. The size can be varied at your request.
我们提供D10、D19、D20、D25、D25.4、D32、D50.8等标准直径，也可以根据您的要求进行调整尺寸。
- Magnetic filter bar is usually made of seamed or seamless 304 stainless steel tubes or 316 stainless steel tubes. The tubes can be fine polished and fully welded to meet food grade or pharmacy application.
磁滤棒一般用304不锈钢管或316不锈钢管使用有缝连接或无缝连接制成。不锈钢管可精细抛光和全焊接，以满足食品级或制药应用。
- Standard working temperature is 80°C, but we can offer up to 350°C to meet your special applications.
标准工作温度为80℃，但我们可以提升至350℃，以满足您的特殊应用。
- By using different grade of rare earth magnets, different magnetic force are available to meet every customer's requirement, the highest magnetic force of diameter 25mm magnetic bar can achieve 12,000GS(1.2T).
采用不同等级的稀土磁铁，可提供不同的磁力以满足每个客户的要求，直径25mm的磁棒最高表磁可达到12000 GS (1.2T)。
- 3000-5000 pieces magnetic filter bars, which is hard to be finished by other factories using argon arc welding, can be welded in one day by our laser welding.
3000-5000根磁滤棒对于其他工厂很难用氩弧焊完成，而我们的激光焊接一天就可以完成。

Item-No. 型号	Diameter 直径	Length 长度	Surface Flux 表磁
NLMR-001	10mm	100-500mm	8000-120000GS
NLMR-002	16mm	100-500mm	8000-120000GS
NLMR-003	19mm	100-500mm	8000-120000GS
NLMR-004	22mm	100-500mm	8000-120000GS
NLMR-005	25mm	100-500mm	8000-120000GS
NLMR-006	32mm	100-500mm	8000-120000GS

Remark : Welcome To Customized Designs
备注：欢迎来定制尺寸



Grate Magnet - Round Series, Square Series 磁力架——圆形系列，方形系列

- Newland Magnetics standard diameter of grate magnet bar is D25mm.
尼兰德磁力架磁棒的标准直径是25mm。
- Mainly two shapes of Grate Magnet: round shape and square shape, provide with many varied sizes for your choice. Single layer or multi-layers can be designed per your request.
磁力架主要有圆形和方形两种形状，有多种尺寸供您选择，也可以根据您的要求设计单层或多层。
- It has excellent performance with no leak, anti-corrosion and long working life.
尼兰德磁力架性能优异，具有无泄漏，抗腐蚀，使用寿命长等优点。
- Easy-clean type can be provided on request.
可根据要求提供易清洗型磁力架。
- All the magnetic bars are waterproof.
所有的磁棒都是防水的。
- Surface: Well polished.
表面处理：抛光。



Magnetic Sweeper-Dry or Wet 磁性清扫器——干性或湿性

Newland magnetic sweeper is ideal for quick and easy picking up hardware, scraps and other metal parts over floors, carpet and even grass. A new kind of magnetic sweeper has also been developed for trapping iron sludge and ferrous muds in water tanks. We can offer different designs of magnetic sweeper.

尼兰德磁性清扫器能够快速且容易地捡起在地面、地毯甚至草地上的五金件，废料和其他金属零件。我们还研制了一种新型的磁清扫器，用于收集水箱中的铁泥和含铁泥。我们可以提供不同设计的磁清扫器。

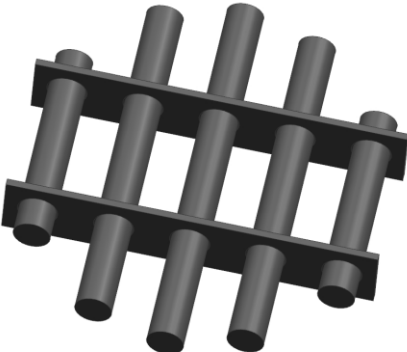
Item-No.	Diameter	Surface Flux	Pictures
RMG-001	D150mm	9000-12000GS	
RMG-002	D200mm	9000-12000GS	
RMG-003	D250mm	9000-12000GS	
RMG-004	D300mm	9000-12000GS	
RMG-005	D350mm	9000-12000GS	

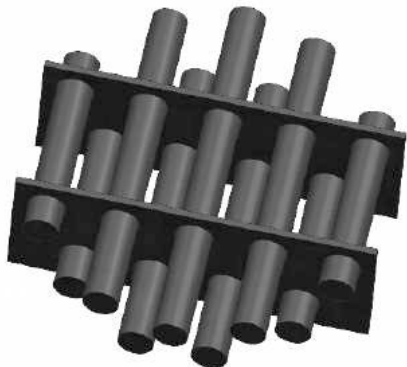
Item-No.	Diameter	Surface Flux	Pictures
DRMG-001	D150mm	9000-12000GS	
DRMG-002	D200mm	9000-12000GS	
DRMG-003	D250mm	9000-12000GS	
DRMG-004	D300mm	9000-12000GS	
DRMG-005	D350mm	9000-12000GS	

Remark : Welcome To Customized Designs

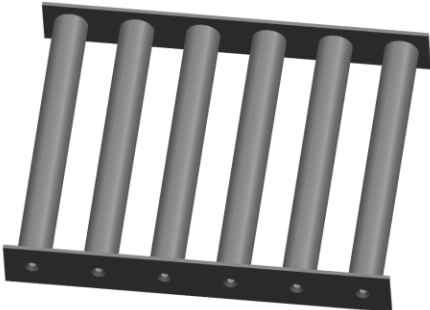
Item-No.	Diameter	Surface Flux	Pictures
SMG-001	150x150mm	9000-12000GS	
SMG-002	200x200mm	9000-12000GS	
SMG-003	250x250mm	9000-12000GS	
SMG-004	300x300mm	9000-12000GS	
SMG-005	350x350mm	9000-12000GS	

Item-No.	Diameter	Surface Flux	Pictures
DSMG-001	150x150mm	9000-12000GS	
DSMG-002	200x200mm	9000-12000GS	
DSMG-003	250x250mm	9000-12000GS	
DSMG-004	300x300mm	9000-12000GS	
DSMG-005	350x350mm	9000-12000GS	

Remark : Welcome To Customized Designs



Magnetic Plate

磁力板

Magnetic Plate can be used in various kinds of processes. They are usually installed above transfer conveyors and vibratory feeders to attract "tramp" type ferrous contamination and any loose machinery that has fallen off during the manufacturing and packaging stages. The magnetic plate consists of two rows of magnetic material running the full length of the plate. It is these rows of magnets that generate the high intensity magnetic flux fields catching "tramp" type contamination. 磁力板可用于各种加工过程。它们通常被安装在传送带和振动给料机上面，以吸引“流浪汉”型的铁污染和任何在制造和包装阶段脱落的松散机械。磁性板由两排磁性材料组成，磁性材料贯穿整个板的长度。正是这两排磁铁产生的高强度磁场捕获了“流浪汉”型污染。

Benefit:

优势:

Suitable for wash down, High collection capacity, Rare Earth strong magnetic field, Easy to clean

适用于洗涤，收集能力强，磁场强，清洗方便

Magnetic Plates are used in industries such as:

磁力板可用于以下领域:

- Plastics 塑料
- Spices 香料
- Chemicals 化工
- Food 食品
- Dyes & Powder Pigments 染料和粉末颜料

Remarks:

备注:

Any contamination is visible if not as a component; it is easy to clean by hand or cloth. But we advise to wear protective gloves to avoid any injuries from sharp attracted items.

如果不是作为组件，任何污染都是可见的;用手或布很容易清洗。但我们建议佩戴防护手套，以避免被尖锐物所伤。



Drawer Magnets remove small-to-medium sized metal impurities from dry free-flowing material.

抽屉式磁力架能从干燥的自由流动的材料中去除中小型金属杂质。

They are widely used in fields of ceramics, chemicals, pharmacy, food, plastic, rubber, dyestuff, mining, environmental protection and etc.

其广泛应用于陶瓷、化工、制药、食品、塑料、橡胶、染料、矿业、环保等领域。

Two models of magnetic drawers are available: Circle-shape and Square-shape

抽屉式磁力架有圆形和方形两种型式。

Drawer Magnet

抽屉式磁力架

No	D	H	L	W	Tubes
RDW-150D	160	290	210	210	5
RDW-200D	220	290	260	260	7
RDW-250D	270	290	310	310	9
RDW-300D	330	290	360	360	11
RDW-150S	160	220	210	210	4
RDW-200S	220	220	260	260	5
RDW-250S	270	220	310	310	6
RDW-300S	330	220	360	360	7

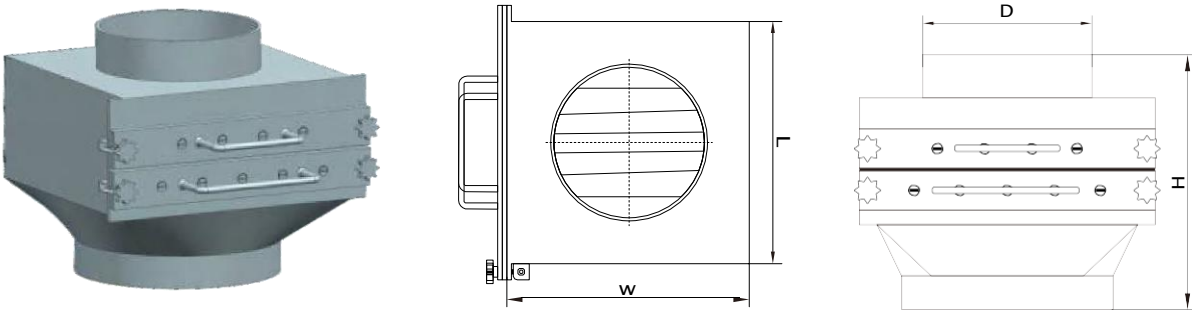

No	H	L	W	Tubes
SDW-200D	270	210	210	15
SDW-250D	270	260	260	20
SDW-300D	270	310	310	40
SDW-350D	270	360	360	50
SDW-400D	270	410	410	70
SDW-200S	200	210	210	10
SDW-250S	200	260	260	18
SDW-300S	200	310	310	35
SDW-350S	200	360	360	40
SDW-400S	200	410	410	60

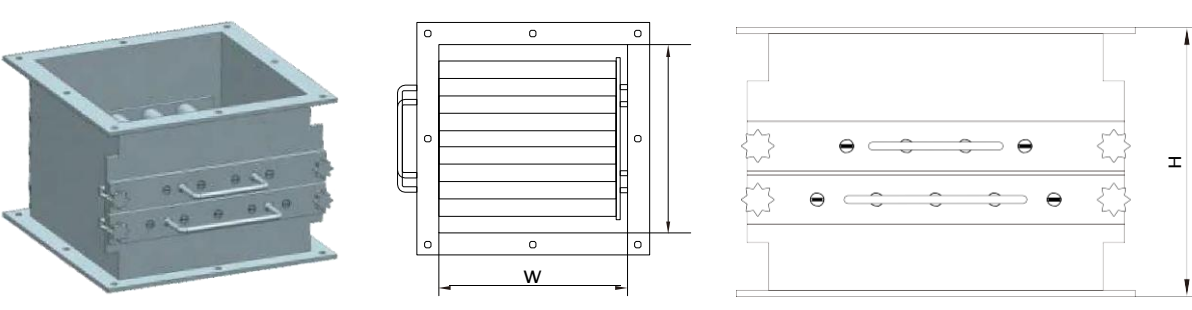

Commercial Magnetic Filter 商用磁性过滤器

Commercial Magnetic Filter is used to remove ferrous particles and other micro contamination. In order to adapt to different working conditions, Newland Magnetics has developed different types of fluid separator.

商用磁性过滤器用于去除铁颗粒和其他微污染。为了适应不同的工作环境，尼兰德开发了不同类型的流体分离器。



- The surface gauss could be chosen from 8000~12000GS.
表面高斯可达8000~12000GS。
- Removes both magnetic and non-magnetic contamination – optional mesh strainer
去除磁性和非磁性污染-可选网状过滤器
- The standard operating temperature $\leq 80^{\circ}\text{C}$. If need, the maximum working temperature is able to be up to 350°C .
标准工作温度 $\leq 80^{\circ}\text{C}$ 。如有需要，最高工作温度可达 350°C 。
- Use flanges clamps, bolts plate, quick release clip or other designs, magnetic parts could be easily installed, removed and cleaned up.
采用法兰夹、螺栓板、快速释放夹或其他设计，磁性部件可以方便地安装、拆卸和清理。
- Material could be 304 or 316 stainless steel.
材料可以是304或316不锈钢。
- Reasonable structural design to ensure the best results, meanwhile high flow capability won't be influenced.
合理的结构设计以确保最佳效果，同时不影响大流量。
- Pressure requirements or other special requirements, could be satisfied according to customer requirements.
可根据客户要求满足压力要求或其它特殊要求。

Central Flow Magnet

粮仓过滤器

Central Flow Magnet is designed to remove ferrous contamination, for example, nuts, bolts, staples and etc, in the gravity pipeline to protect your equipment. No energy cost, no pollution, easy installation and cleaning. The core of central flow magnet is bullet magnet made of strong permanent magnet and stainless steel. Bullet shape helps spread flow material thereby improving separation efficiency of the system. Permanent magnets produce strong magnetic flux field to catch ferrous contamination. Safety interlocks could avoid the door being opened accidentally. 粮仓过滤器用于清除重力管道中的铁污染，如螺母、螺栓、订书钉等，以保护您的设备。没有能源损耗，无污染，安装和清洗方便。粮仓过滤器的核心是由强永磁体和不锈钢制成的子弹型过滤器。子弹形状有助于在流动材料中运动，从而提高系统的分离效率。永磁体产生强大的磁场以捕捉铁污染。安全联锁可以避免门被意外打开。

No.	A	B	C	H
CFM-1	50	150	110	400
CFM-2	80	190	170	550
CFM-3	110	170	220	590
CFM-4	160	230	280	660
CFM-5	200	280	360	770
CFM-6	250	330	430	860
CFM-7	300	400	490	890
CFM-8	400	490	620	1110

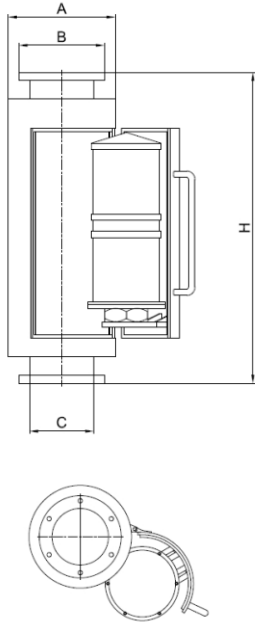

Benefits:
优势:
Easy to inspect, Maintains full flow, High collection capacity, Reduces 'spark' risk, Removes 'tramp' sized contaminants, Rare earth deep magnetic field. 易于检查，保持全流量，高收集能力，降低“火花”风险，去除“流浪汉”型污染物，强磁场。

Central flow magnets are used in industries such as:
粮仓过滤器可被用于以下领域:

■ Plastics 塑料	■ Food 食品	■ Spices 香料
■ Chemicals 化工	■ Dyes & Powder Pigments 染料和粉末颜料	

Remarks:
备注:
It is advisable to wear protective gloves to avoid any injuries from sharp attracted items.
建议佩戴防护手套，避免被尖锐的异物划伤。



Milk Filter

牛奶过滤器

Bottom open construction can meet easy operating need. Inside of shell is mirror polished with no roughness and sanitary dead corner. Multiple element connection type can apply for all kinds of filter cartridge designed to withstand years of field and plant operation. 底开式结构，操作方便。外壳内部镜面抛光，表面不粗糙、无卫生死角。多元式连接可适用于各种滤芯，使其能够在牧场和工厂长年累月运行。

The container usually is made of stainless steel 316 or stainless steel 304. Inlet and outlet's type can be flange, clamp, NPT that are easy to use in operating system. Cartridge filter have been designed for high purity and critical applications. 容器通常采用不锈钢316或不锈钢304制成。进、出口型式可采用法兰式、夹紧式、NPT式，是操作系统便捷易使用。筒式过滤器专为高纯度和关键应用而设计。

- Benefit:**
优势:
- Remove 99% mechanical impurities from the milk, including concrete and manuredust,hair, andmanyothersurprisesinmilk. 去除牛奶中99%的机械杂质，包括混凝土和粪便灰尘，头发和牛奶中的其他污染物。
 - Clear from products of mastitis up to 52% 清除产品中乳腺炎细菌可达52%。
 - Improve the organoleptic characteristics of the finished product 改善成品外观色泽。
 - Reduce bacterial contamination up to 63% 减少细菌污染可达63%
 - Prevent acidification 防止酸化
 - Increase thermal stability of milk 提高牛奶的热稳定性
 - Guarantee upgrading of milk 提高牛奶品质
 - Increase the shelf life of milk 延长牛奶保质期

Operating Parameters

工作参数

Max Operating Pressure: 0.7MPa Max
最大工作压力: 0.7MPa
Operating Temperature: 110°C Pressure
工作温度: 110° C
Tolerance on Weld: 0.85
焊接误差: 0.85

